

Exhibition floor plan

2F

Front of Room A

Exhibitors	
G1,G2,G3	DuPont
G4	SCREEN Semiconductor Solutions Co., Ltd.
G5	Takatori Corporation
G6,G7	TOYOTA TSUSHO CORPORATION
G8	mi2-factory GmbH
G9	Dongguan Tianyu Semiconductor Technology Co., Ltd. (TYSIC)

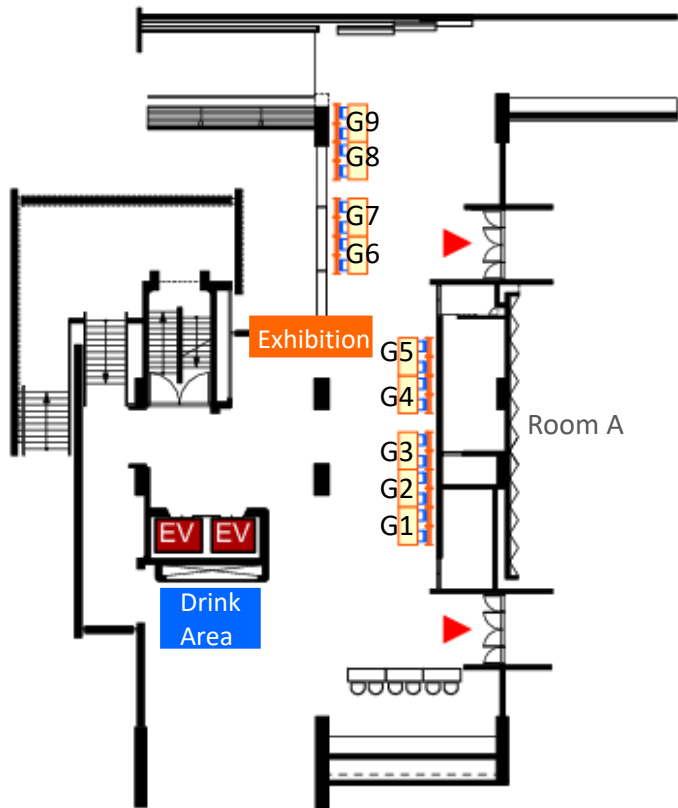

1F

Front of Room 103/104

Exhibitors	
F1	HIGHTEC SYSTEMS CORPORATION
F2	SUMITOMO SEIKA CHEMICALS CO.,LTD.
F3,F4	II-VI Incorporated
F5	Epiluvac
F6	Ion Technology Center Co.,Ltd
F7	UniTemp Japan Co., Ltd.

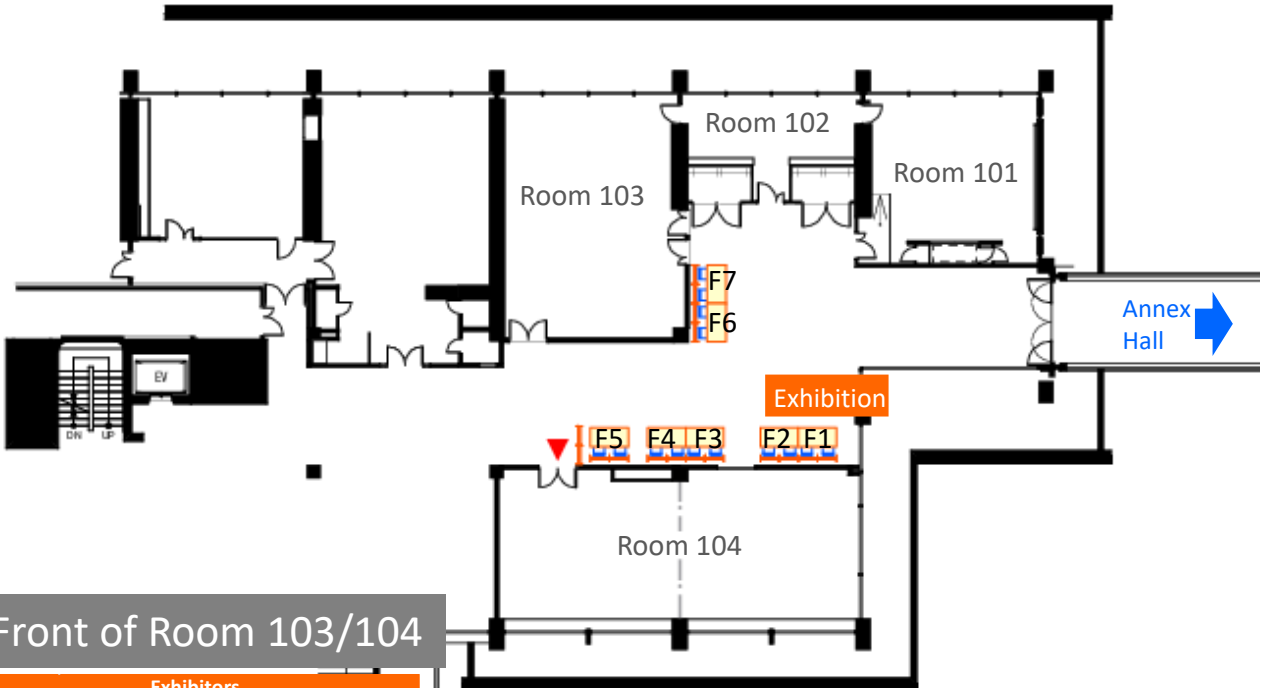

Monday 09:00 – 18:00
 Tuesday and Wednesday 08:30 – 18:00
 Thursday 08:30 – 16:00
 Friday 08:30 – 14:00

Conference Registration required for admission.

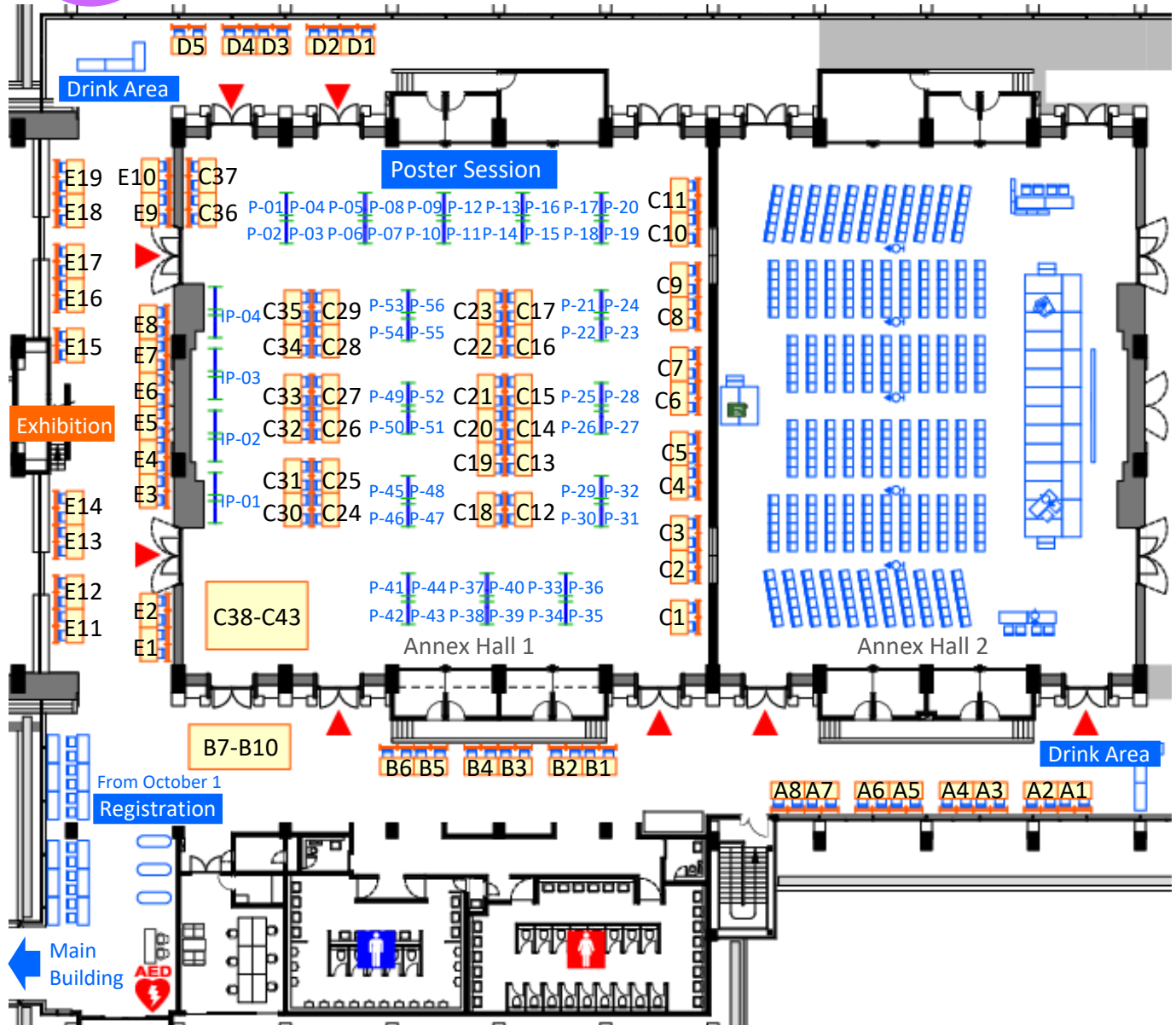

Exhibitors			
A1	Toray Research Center, Inc.	E1	Saito Optical Science Ltd.
A2	AYMONT TECHNOLOGY, INC.	E2	TOKYO ELECTRON LTD.
A3	Synopsys	E3, E4	Japan Science and Technology Agency City of Kyoto
A4	NOVASIC	E5, E6, E7	ASTEM (Advanced Science, Technology & Management Research Institute of KYOTO) Kyoto Municipal Institute of Industrial Technology and Culture
A5	Toyo Tanso Co., Ltd	E8	NISSIN GIKEN CORPORATION
A6	ACME Electronics Corporation	E9	NORITAKE CO., LIMITED
A7	DAIJIN	E10	Mitsui Bussan Electronics Ltd.
A8	RevoDeve	E11	Mipox Corporation
B1, B2	SHOWA DENKO K.K.	E12	Pallidus, Inc
B3, B4	Mitsubishi Electric Corporation	E13	STR Japan K.K.
B5, B6	AIXTRON	E14	Synova SA
B7-B10	ROHM Co., Ltd.	E15	Foundation for Promotion of Material Science and Technology of Japan (MST)
C1	Saint Gobain	E16	U-MAP Co.,LTD
C2, C3	Sumitomo Electric Industries. Ltd.	E17	ADM MAP Inc. (a Ferrotec group company)
C4, C5	LPE S.p.A	E18	NIKKA SEIKO CO., LTD.
C6	KLA Corporation	E19	PR HOFFMAN MACHINE PRODUCTS
C7	Fraunhofer IISB		
C8	Ceramicforum Co., Ltd		
C9	NIDEX CO.,LTD.		
C10, C11	GT Advanced Technologies		
C12	BRUKER SEMI		
C13	Hakuto Co., Ltd		
C14, C15	centrotherm		
C16	WaferMasters, Inc.		
C17	Fujikin Carp Group		
C18	NISSIN ION EQUIPMENT CO. LTD		
C19	Lasertec Corporation		
C20	Hitachi High-Technologies Corporation		
C21	RIGAKU CORPORATION		
C22	Samco Inc.		
C23	ROKKO ELECTRONICS Co.,Ltd.		
C24, C25	Revasum		
C26, C27	TanKeBlue Semiconductor Co. Ltd. / New Metals and Chemicals Corporation, Ltd.		
C28	Silvaco Japan		
C29	X-Fab		
C30	NuFlare Technology, Inc.		
C31	Nanotronics		
C32, C33	Microdiamant		
C34	Eurofins EAG		
C35	Engis Corporation		
C36	Hebei Synlight Crystal Co., Ltd.		
C37	OS TECH CO., LTD.		
C38-C43	Wolfspeed		
D1	TCK (Tokai Carbon Korea)		
D2	Sinmat Commercial LLC		
D3	SEMILAB		
D4	Epiworld International Co., LTD		
D5	Nippo Precision Co.,Ltd,		